



POTENTIOMETER

PRV4



Panel Potentiometer

KEY BENEFITS

- High 2-W power rating
- Offers US bushing threads and a fully-sealed IP67 package
- Features 19.6-mm diameter; provides a compact alternative to the MIL RV4
- Cermet element for increased stability; high stability vs. carbon (down to $\pm 3\%$ drift after 1000 hours)
- Nickel-plated brass shaft provides greater reliability and robustness; custom shafts available
- Low 1% typical contact resistance variation
- Operating temperature range of $-55\text{ }^{\circ}\text{C}$ to $+125\text{ }^{\circ}\text{C}$; ensures reliable operation even in extreme environments
- Utilizes faston 2.86 connections

APPLICATIONS

- Control panels
- Heavy-duty and off-road controls
- Position controls

Datasheet is available on our web site at www.vishay.com
for PRV4 - <http://www.vishay.com/doc?50004>

Industrial Potentiometer



FEATURES

- High power rating 2 Watt at 70 °C
- Full sealing
- Low contact resistance variation (1 % typical)
- Robust nickel plated brass shaft
- Use of faston 2.86 connections
- Cermet element
- Electrical performance in accordance with MIL-PRF-94 standards



RoHS COMPLIANT

DIMENSIONS in millimeters
PRV4F

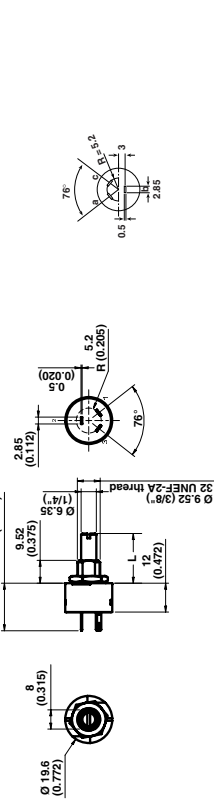

LENGTH L	1/2"	7/8"	2"
SHAFT CODE	GBS	GUS	GFS

PRV4 LPRP - WITH LOCATING PEG

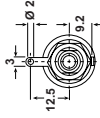

CIRCUIT DIAGRAM

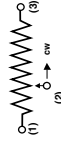

SPECIAL FEATURES
COMMAND SHAFT

Length is measured from the mounting surface to the free end of the shaft. The screwdriver slot is aligned with the wiper within ± 10°. Special shafts are available, in accordance to drawings supplied by customers. We recommend that customers should not machine shafts, in order to avoid damage. Bending or torsion of terminals should also be avoided.

LINEARITY

The typical linearity of linear variation law potentiometers is ± 5 %. Guaranteed linearity on request. Consult VISHAY.

ELECTRICAL SPECIFICATIONS

Resistive Element	cermet
Electrical Travel	270° ± 10°
Resistance Range	20 Ω to 10 MΩ 100 Ω to 2.5 MΩ
Standard series	1 - 2 - 2.5 - 5
Tolerance	± 20 % ± 10 %
Power Rating	2 W at + 70 °C 1 W at + 70 °C
Temperature Coefficient	See Standard Resistance Element Data
Limiting Element Voltage (Linear Law)	500 V
Contact Resistance Variation (Typical)	1 %, Rn or 3 Ω
End Resistance	4 Ω
Dielectric Strength (RMS)	1500 V
Insulation Resistance (500 VDC)	10 ⁴ MΩ

MECHANICAL SPECIFICATIONS

Mechanical Travel 300° ± 5°
Operating Torque (max. Ncm) 3 typical (4.3 oz. inch)
End Stop Torque (max. Ncm) 70 (6 lb. inch)
Max Tightening Torque of Mounting Nut (Ncm) 200 (17.3 lb. inch)
Unit Weight (max. g) 23 to 32 (0.82 oz to 1.14 oz)

ENVIRONMENTAL SPECIFICATIONS

Temperature Range - 55 °C to + 125 °C
Climatic Category 55/125/10
Sealing fully sealed container IP67

POWER RATING CHART

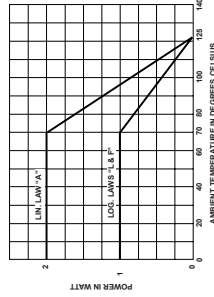

RESISTANCE LAWS

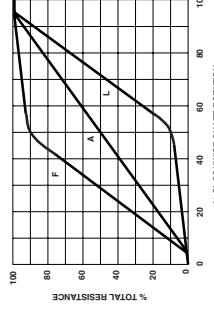

Revision 21 - Sep-06

NOTICE Specifications of the products displayed herein are subject to change without notice. Vishay Intertechnology, Inc., or anyone on its behalf, assumes no responsibility or liability for any errors or inaccuracies. Information contained herein is intended to provide a product description only. No license, express or implied, by estoppel or otherwise, to any intellectual property rights is granted by this document. Except as provided in Vishay's terms and conditions of sale for such products, Vishay assumes no liability whatsoever and disclaims any express or implied warranty, relating to sale and/or use of Vishay products including liability or warranties relating to fitness for a particular purpose, merchantability, or infringement of any patent, copyright, or other intellectual property right. The products shown herein are not designed for use in medical, life-saving, or life-sustaining applications. Customers using or selling these products for use in such applications do so at their own risk and agree to fully indemnify Vishay for any damages resulting from such improper use or sale.

For technical questions, contact sfer@vishay.com